

*Balteau NDT is known for its unique and unequalled engineering and manufacture of portable equipment. The CERAM 35 is the results of the latest evolution of electronic and physics of X-rays. It has been engineered to meet and exceed your needs for now and the future.*

*The CERAM 35 is delivering 300 kV and 5 mA with a duty cycle of 100% for an incredible image contrast even at full power. Thanks to a purposely designed tubehead and driving electronics, the CERAM 35 is offering to the user both duty cycle and an enormous power to fit any important requirements.*

*Gas insulation and right components selection have succeeded in producing one of the lightest 300kV in the market. Combined to one of the two available type of control units (CF2000 or Hand X), the unit is extremely versatile and is confirming our reputation of builders for machines that are really made for field inspection.*



### **Ceramic tubehead**

The name CERAM comes from that particularity: the tubehead is a ceramic tubehead with copper external anode and a beryllium window. The tubehead is placed on the high voltage transformer with spring loaded connectors to assure permanent but flexible contacts even when heat dilates the assembly. The fixing of the tube is done through the anode which is a plain copper gasket which can better face industrial life than similar glass tubes. The cooling of such tube is also more efficient than with the conventional glass tubes that are enclosed into the can. This leads to a duty cycle of up to 100%.

### **Efficient cooling**

On top of the anode, where the heat is mostly generated, is placed a powerful low voltage fan that is cooling down the generator. The integrated air cooling system is self sufficient to assure continuous use even in harsh environments without the need of water cooling.

### **Pulsed wave high voltage generator**

Pulsed wave technology is the only acceptable compromise between power and contrast which are representing Economy and Quality requirements. Every minute spent in getting an exposure done is largely contributing to the final cost of the inspection. Therefore, a vast majority of users are tempted to get fast exposures at higher voltages or current than those generally necessary for the application. When a too hard high voltage value is used, contrast gradually disappears due to the shape of the spectrum.

Pulsed wave generators can drive a higher current at full power and will still keep an extremely broad spectrum to guarantee that soft X rays will be present even at full kV giving a contrast that is not achievable with any other techniques at same kV.

### **Energy savers**

Power waste is concerning every industry and all actions contributing to the decrease of wasted energy can create big savings when added one to one. An efficient system can only be if the regulation of power supply is efficient and if the technology used is the most advanced. The technology we have used in the high voltage transformer cuts the power need by two to produce the same output on a competitor product. On the regulation side, our units can accept wide variations on the input without effect on the output.

### **Field operation**

All our portable units are designed to operate on power generator when required. Safety oriented, our units are Bright yellow to be easily sight located and can even be equipped with additional lights on the can that will indicate the working status (option). A specific micro chip identifies each generator and brings our control unit the ability to instantaneously recognize the equipment connected and adapt the best parameters to drive the new generator.

Our main connectors are original military CANON plugs for years.

## Specifications

### Mechanical

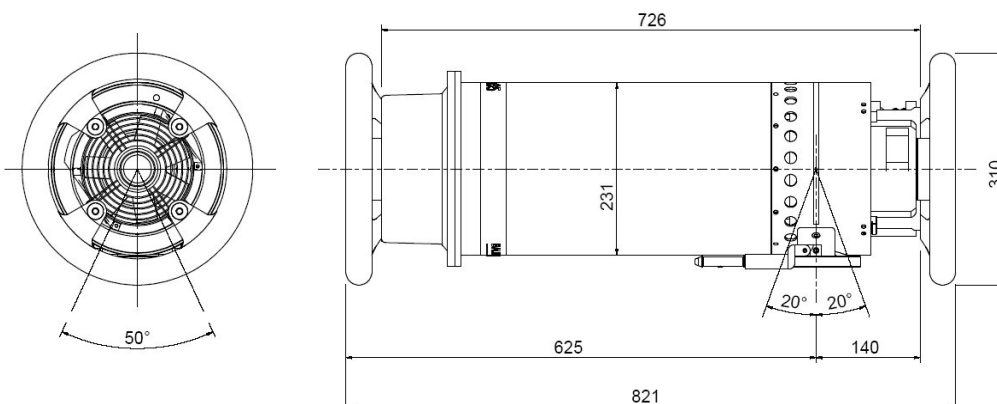

Weight without rings : 29 kg

### Electrical

High voltage range	kV	100 – 300
Tube current range	mA	0,1 – 5
Duty cycle		100%
Insulation		SF6 gas
Mains	V	180-260

### X-ray tube

Beam angle		40°
Focal spot size (IEC336)		2,5 x 2,5
Inherent filtration	mm	1 Be
Anode cooling type		Air

### Environmental

Operating temperature	°C	Max. 70
-----------------------	----	---------

### Standard equipments

Internal pressure gauge, heavy duty lock type connector, 20 m connecting cable, quick release SF6 valve, heavy duty rubber coated hand rings, holder for centering device filter and diaphragm.

### Optional accessories

Lead shutter, warning light, warning light repeater, bag for accessories, transport case, cradle, support stand, hydraulic stand, 100-260 V adapter.

### Producer

#### **Balteau NDT sa**

Voie de Liège, 12  
B-4681 Hermalle Sous Argenteau  
BELGIUM

Tel.: +32 4 374 75 75

Fax: +32 4 374 75 85

E-mail: [balteau@balteau-ndt.com](mailto:balteau@balteau-ndt.com)

Website: [www.balteau.com](http://www.balteau.com)

### Distributor